

ONOVILLE MARINA

P.O. Box "B" Steamburg NY 14783

Telephone (716) 354-2615

Fax (716) 354-9256



2021 SEASON FEES

April 30th to September 20th, 2021

Docking	Day	Week	2 Weeks	Season
Non-Electric Slips				(per Ft / Min.)
Slip Size "A" boats to approx. 20'	\$16.00	\$80.00	\$136.50	\$27.32 / \$ 546.39
Slip Size "B" boats to approx. 24'	\$16.00	\$80.00	\$136.50	\$31.22 / \$ 749.34
Slip Size "C" boats to approx. 28'	\$16.00	\$80.00	\$136.50	\$32.52 / \$ 910.66
Slips with Electric				
Slip Size "D" boats to approx. 24'	\$18.00	\$110.00	\$168.00	\$34.73 / \$ 833.49
Slip Size "E" boats to approx. 28'	\$18.00	\$110.00	\$168.00	\$34.73 / \$ 972.40
Slip Size "F" boats to approx. 32'	\$19.00	\$120.00	\$168.00	\$44.45 / \$1422.48
Slip Size "G" boats to approx. 36'	\$20.00	\$130.00	\$168.00	\$47.24 / \$1700.31
Slip Size "H" boats to approx. 40'	\$22.00	\$140.00	\$168.00	\$52.79 / \$2111.50
Slip Size "I" boats to approx. 44'	\$23.00	\$150.00	\$210.00	\$52.79 / \$2322.65

(Slips with 50 ampere shorepower / add \$50.00)

Watercraft Access / Ticket	\$ 6.00 Daily	\$ 27.00 Week	\$ 90.00 Season
Watercraft Access w/ Parking	\$ 32.00 per week	\$ 230.00 Season for boats / units up to 28'	\$ 11.00 per foot more for boats / units over 28'
Vehicular Access	\$ 4.00 Daily	\$ 30.00 Season	
Seasonal Trailer Storage	\$ 3.00 per foot of boat length		
Pumpout Fee	\$ 3.00 per token		
Launch and Park Pass / Personal Watercraft / Single Unit		\$ 32.00 per week	\$ 115.00 / Season
Camping	\$ 30.00 Day	\$ 120.00 Week	\$1575.00 Season
Tent (1) w / primary camping unit	\$ 14.00 / Day extra		

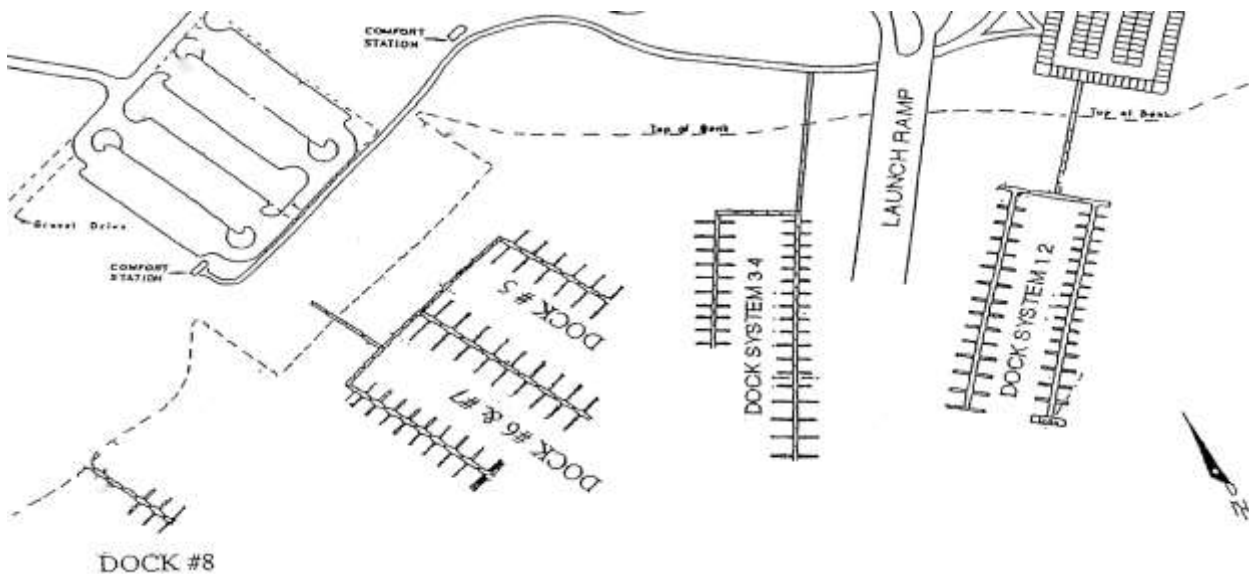

ONOVILLE MARINA EAST CAMPGROUND

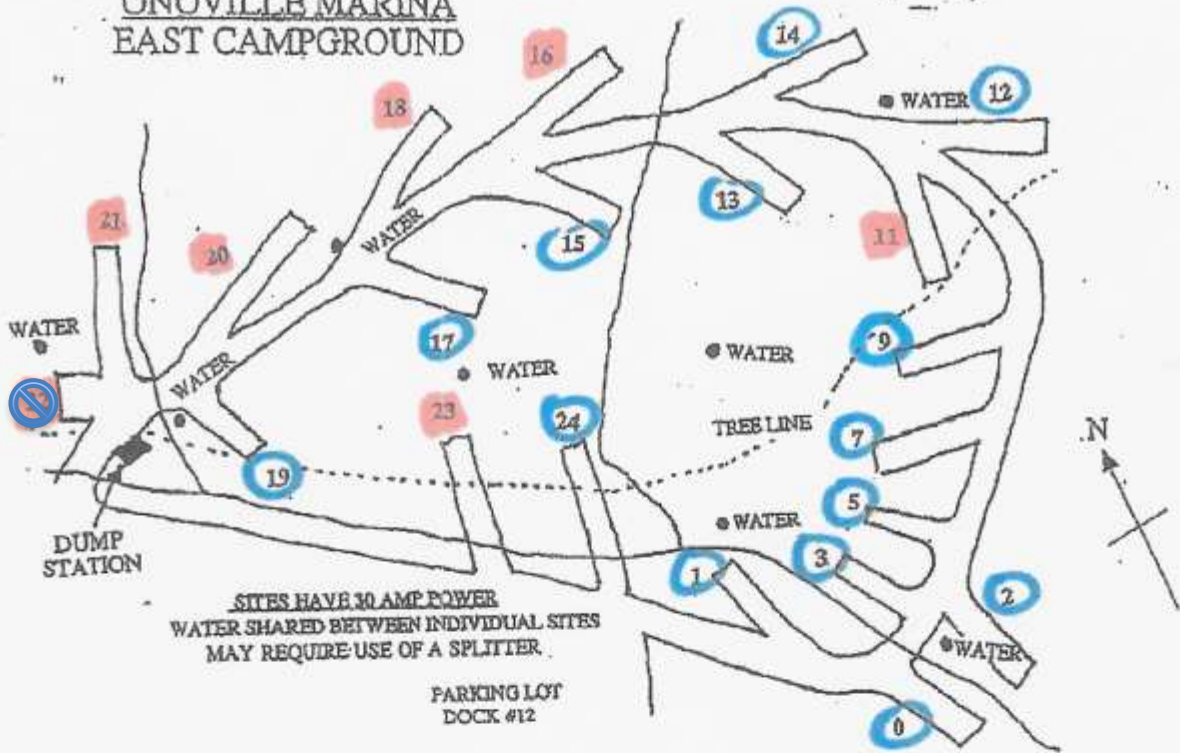

SITES HAVE 30 AMP POWER
WATER SHARED BETWEEN INDIVIDUAL SITES
MAY REQUIRE USE OF A SPLITTER.

PARKING LOT
DOCK #12

ONOVILLE MARINA WEST CAMPING AREA

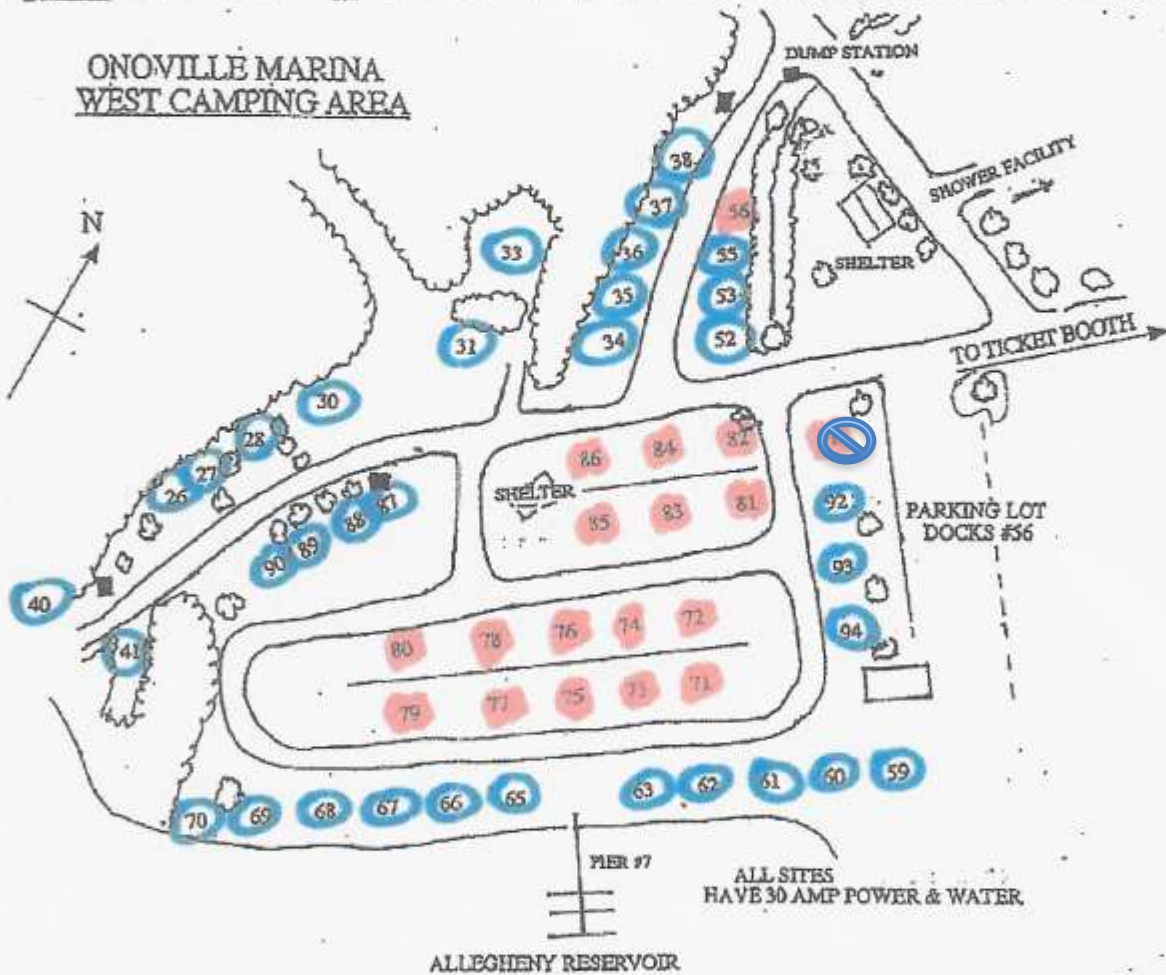

ALL SITES
HAVE 30 AMP POWER & WATER.

ALLEGHENY RESERVOIR

= Seasonal Sites = Transients